

**RYNO<sup>®</sup>**

Dining  
Chair 2.0



**Pineapple**





Introducing the **Ryno dining chair 2.0**, the next evolution of our trusted seating solution designed specifically for mental health environments.

Building on the success of the original Ryno dining chair, first launched in 2013, this latest design combines proven durability with enhanced comfort and safety. With a more generous seat width, the 2.0 offers an improved sitting experience, supporting the wellbeing of service users over extended periods.

The chair's flowing, tapered form has been carefully engineered to improve stability and minimize the risk of overturning, protecting people from harm. The organic shape and subtle sensory ripple details have been thoughtfully crafted to soften the built environment, creating a calmer, more welcoming atmosphere.

Beyond comfort and design, practicality remains at the core of the Ryno Dining 2.0. The chair is 100% waterproof, with a hygienic wipe-clean surface which is easily kept clean. Made entirely from recyclable materials, it not only supports sustainability but also reinforces our commitment to long-lasting, responsible design.



# DESIGNED FOR PEACE OF MIND



## Lifetime guarantee

Like all Ryno products, the dining 2.0 chair is protected by a lifetime guarantee against manufacturing faults, giving you total peace of mind.



## Waterproof

Made from a single piece of rotationally molded polyethylene with no joins, this chair is totally waterproof.



## Damage resistant

The single-piece construction helps to distribute stresses throughout the product, making it extremely resistant to damage.



## Hygienic

The polyethylene material is naturally resistant to bacteria and bedbugs by providing no organic matter as a source of food.



## 100% recyclable

Made from 100% polyethylene, at the end of their life this chair can be returned and recycled again.





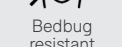
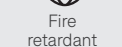
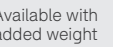
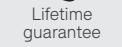
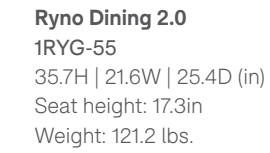

## OPTIONS

- Lightweight model (24lbs)
- Anti-concealment base plate
- Hidden floor fixing solution
- Wide range of versatile shell colors

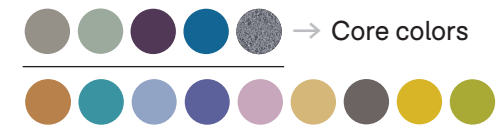







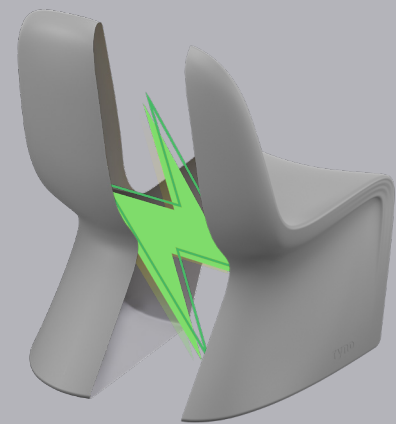

## STATE OF THE ART *SUSTAINABLE* MANUFACTURING

As well as being 100% recyclable, Ryno® products manufactured using our latest technology are more eco-friendly than ever:

- The electricity used to manufacture these products is generated from renewable sources.
- The latest technology allows us to finely control wall thicknesses in different areas of the chair, making it stronger where in needs to be, and using less material in other areas.
- Energy wastage has been minimized, helping to reduce carbon emissions.

# See for yourself...

To arrange a demonstration or book a visit to our showroom, please call 800.496.9324

## **Pineapple USA**

7105 19 Mile Rd, Sterling Heights, MI 48314

**T**

800.496.9324

**E**

[inquiries@pineapplecontracts.com](mailto:inquiries@pineapplecontracts.com)

**W**

[us.pineapplecontracts.com](http://us.pineapplecontracts.com)

# Pineapple